

New 600x600 9U
data cab to be fitted
at high level

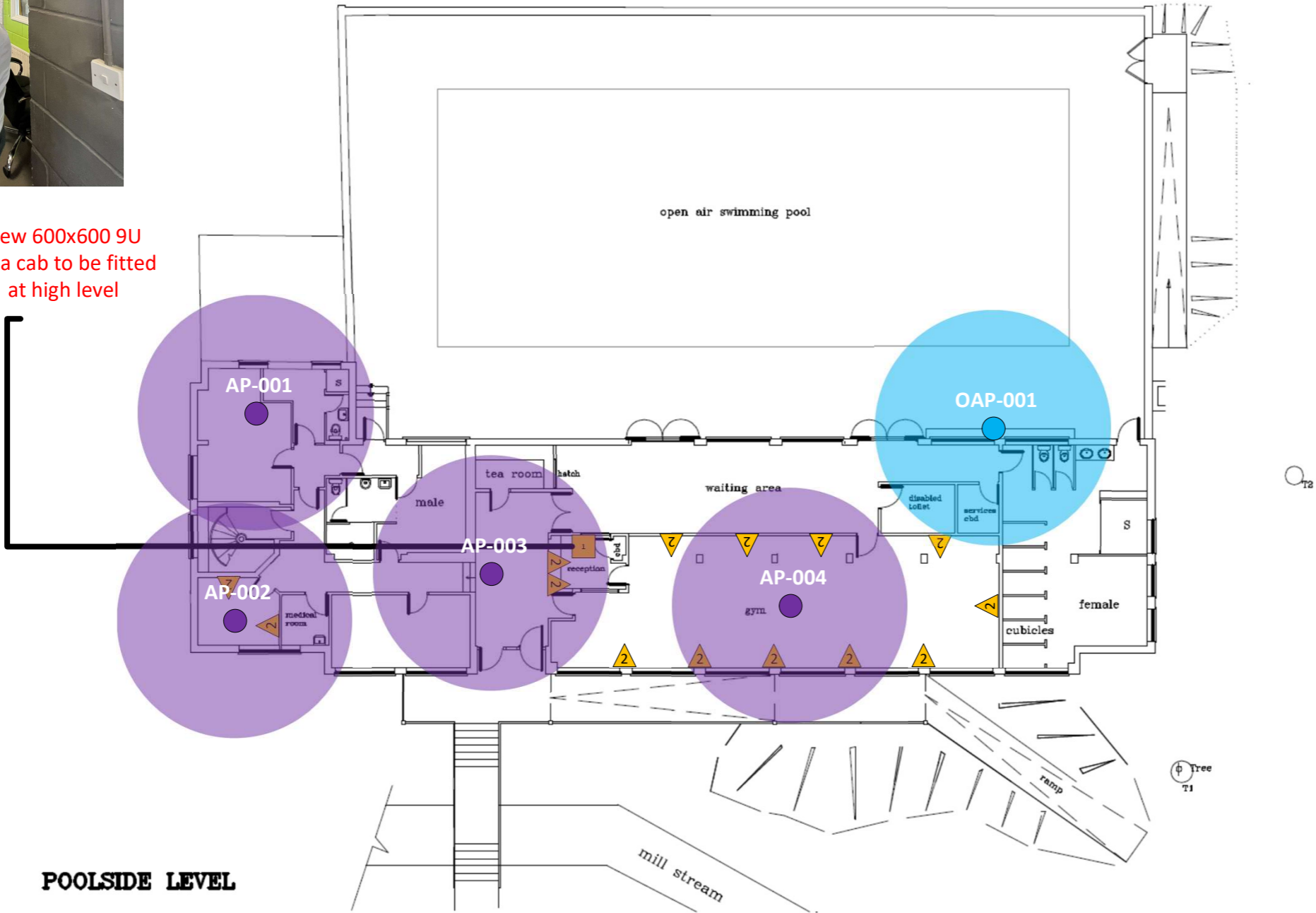

POOLSIDE LEVEL



Notes

Key

- 1 Data Cab
- 2 Double Data Points
- Access Point
- Outdoor Access Point
- 4 Quad Data Points

Client

Chesham Moor Gym & Swim,
Moor Rd,
Chesham,
HP5 1SE

Main Contractor

Advanced IT Services
Beechwood Park
Elveston
Derbyshire
DE72 3EQ



Project

Chesham Gym&Swim

Document Title

AIT_Chesham_Gym&Swim_FF

Drawn By

A.Woodward

Date

10/08/2022

Scale

N/A



Notes

- Key
- 1 Data Cab
 - 2 Double Data Points
 - Access Point
 - Outdoor Access Point
 - 4 Quad Data Points

Client
Chesham Moor Gym & Swim,
Moor Rd,
Chesham,
HP5 1SE

Main Contractor
Advanced IT Services
Beechwood Park
Elveston
Derbyshire
DE72 3EQ



Project
Chesham Gym&Swim

Document Title
AIT_Chesham_Gym&Swim_FF

Drawn By
A.Woodward

Date
10/08/2022





Scale
N/A



GROUND LEVEL

Notes

Key

-  Data Cab
-  Double Data Points
-  Access Point
-  Outdoor Access Point
-  Single Data Points

Client
Chesham Moor Gym & Swim,
Moor Rd,
Chesham,
HP5 1SE

Main Contractor
Advanced IT Services
7 Acton Street
Long Eaton
Nottingham
NG10 1FT



Project
Chesham Gym & Swim

Document Title
AIT_Chesham_Gym&Swim_Referb

Drawn By
A.Woodward

Date
10/08/2022

Scale
N/A

