

Electrical Notes:

**Electrical**

All electrical work required to meet the requirements of Part P (electrical safety) must be designed, installed, inspected, and tested by a competent person registered under a competent person self-certification scheme such as BRE certification Ltd, BSI, NICEIC Certification Services or Zurich Ltd. An appropriate BS7671 Electrical Installation Certificate is to be issued for the work by a person competent to do so. A copy of a certificate will be given to Building Control on completion.

**Internal Lighting**

Install low energy light fittings that only take lamps having a luminous efficiency better than 80 lumens per circuit watt. All fixed to have lighting capacity (lm) 185 x total floor area, to comply with Part L of the current Building Regulations and the Domestic Building Services Compliance Guide.

- Cable Routes**
1. Cables generally: Conceal wherever possible.
    - 1.1. Concealed cable runs to wall switches and outlets: Align vertically or horizontally with the accessory.
  2. Exposed cable runs: Submit proposals.
    - 2.1. Orientation: Straight, vertical and/ or horizontal and parallel to walls.
  3. Distance from other services running parallel: 150 mm minimum.
    - 3.1. Heating pipes: Position cables below.

- Installing Cables**
1. General: Install cables neatly and securely. Protect against accidental damage, adverse environmental conditions, mechanical stress and deleterious substances.
  2. Timing: Do not start internal cabling until building enclosure provides permanently dry conditions.
  3. Jointing: At equipment and terminal fittings only.
  4. Cables passing through walls: Sleeve with conduit bushed at both ends.
  5. Cables surrounded or covered by thermal insulation: Derate accordingly.
  6. Cable guards: Fit where cables are vulnerable to mechanical damage

- Installing Cables in Plaster**
1. Protection: Cover with galvanized steel cable capping nailed to substrate

- Installing Cables in Trunking / Ducts**
1. Support: Pin racks or cleats at each floor level or at 5 m vertical centres, whichever is less.
  2. Heat barrier centres (maximum): 5 m.
  3. Heat barriers: Required except where fire resisting barriers are not provided.

Electrical Symbol Key:

- 50 amp cooker control with 13 amp switched socket outlet.
- Consumer unit to BS 7671:2011 compliant non-combustible enclosure consumer unit
- CO/Heat/smoke detector- mains operated and linked back to existing fire alarm system
- Flourescent tube Low energy fitting
- Exterior feature lighting operated with override switch control and movement Sensor LED
- Recessed IP65 spot light fitting. All low energy bulbs- 7 watt LED's.
- Recessed ceiling spot light with low energy bulbs- 7 watt LED's.
- Pendent light fitting for LED bulb
- Interior downlighting strip LED
- Exterior downlighting strip LED
- Interior uplighting LED
- Wall light fitting for LED light bulb
- Low Level external LED lighting 7 watts
- Low Level external low energy LED up lighting
- Floor socket & USB outlet for lighting circuit connected back to dimmers switch
- 13 amp Double switched socket outlet above work surface level
- 13 amp Double switched socket outlet built into worktop with USB socket.
- 13 amp Double switched socket outlet
- 13 amp Double switched socket outlet with intergrated USB Charging Ports
- 13 amp fused neon switch with wire outlet
- 7 Kw- Double socket outlet car charging point fixed to wall with fuse.
- Room stat temperature control
- RJ45 ethernet connection outlet connected back to new cat7 cabling (tbc with client)
- Shaving outlet
- Telephone outlet connected back to existing telecommunications
- Coaxial cable outlet point for conventional and sky television
- 13 amp switched fused spur with low level socket outlet (above worktop connected to socket below worktop)
- High level fan isolator switch (positioned above door where appropriate)
- In line duct fan with isolator switch (positioned above door where appropriate)
- 3 way light switch / gang of switches if required
- 2 way light switch / gang of switches if required
- 1 way light switch / gang of switches if required
- CCTV Camera Position New linked back to existing CCTV system.

Rev B 10/07/2025 MVL Amended drawings for tender issue.

Rev A 20/06/2025 MVL Amended drawings following meeting with Client 06/06/2025

REVISIONS	ID	DATE	BY	COMMENTS
DRAWING TITLE First Floor Electrical Plan.				
JOB Horley Town Council				
Horley Town Council 92 Albert Road Horley Surrey RH6 7HZ				
CLIENT Mr Sam Adeniji				
INSTIGATION DATE 18th Feb 2025		SCALE 1:50 @ A1	DRAWN BY: MVL	CHECKED BY: CVL
DRAWING No. L-1680-4-601			REVISION: B	

MVL

ARCHITECTS

MALCOLM V. LELLIOTT

19 CHURCH ST, GODALMING, SURREY, GU7 1EL

45 KINGS ROAD, ALTON, HAMPSHIRE, GU34 1PX

THE COACH HOUSE, DOCK STREET, PENARTH, CF64 2LA

E-MAIL: ADMIN@MVL-ARCHITECTS.CO.UK

E-MAIL: ADMIN@MVL-ARCHITECTS.CO.UK

E-MAIL: ADMIN@MVL-ARCHITECTS.CO.UK

TEL 01483 416 411

TEL 01420 375 083

TEL 02920 090 130

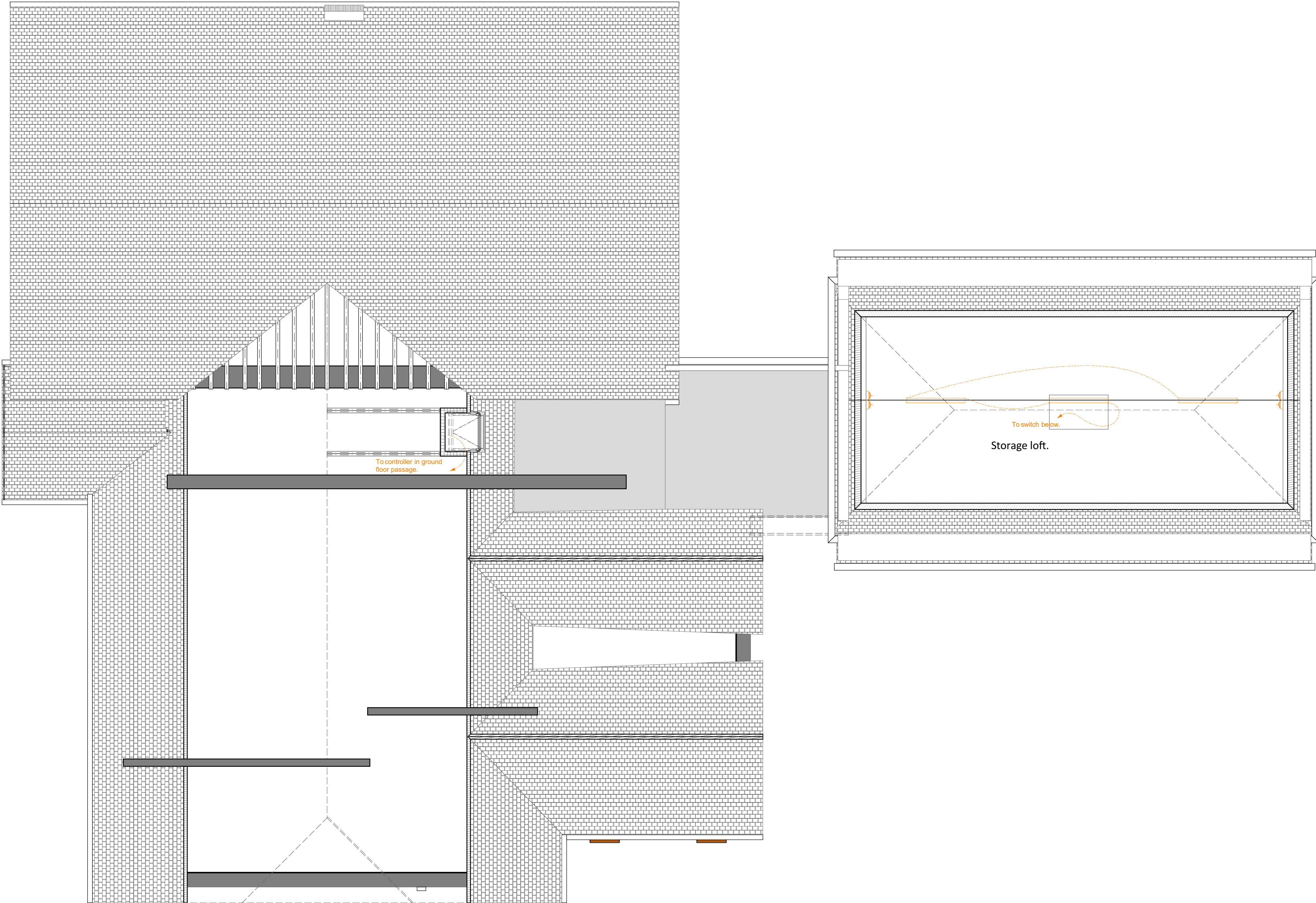

TENDER ISSUE

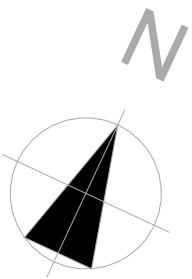

Scale Bar @ 1:50



DO NOT SCALE THIS DRAWING EXCEPT FOR PLANNING PURPOSES

© COPYRIGHT

UNDER THE PROVISIONS OF THE COPYRIGHT ACT 1988, THE COPYRIGHT OF THIS DRAWING AND THE WORK CONTAINED THEREIN REMAINS THE PROPERTY OF THE DESIGNER MALCOLM V. LELLIOTT LTD. AND MAY NOT BE REPRODUCED IN ANY FORM WHATSOEVER WITHOUT PRIOR WRITTEN CONSENT. FIGURED DIMENSIONS ARE TO BE USED IN PREFERENCE TO SCALED SIZES AND ALL DIMENSIONS MUST BE CHECKED ON SITE BY THE CONTRACTOR BEFORE COMMENCING WORK. NO DEVIATION FROM THIS DRAWING WILL BE PERMITTED WITHOUT THE PRIOR WRITTEN CONSENT OF THE DESIGNER.