

TYPICAL SOUND INSULATION
TO INTERNAL SOIL STACK
DETAIL:09

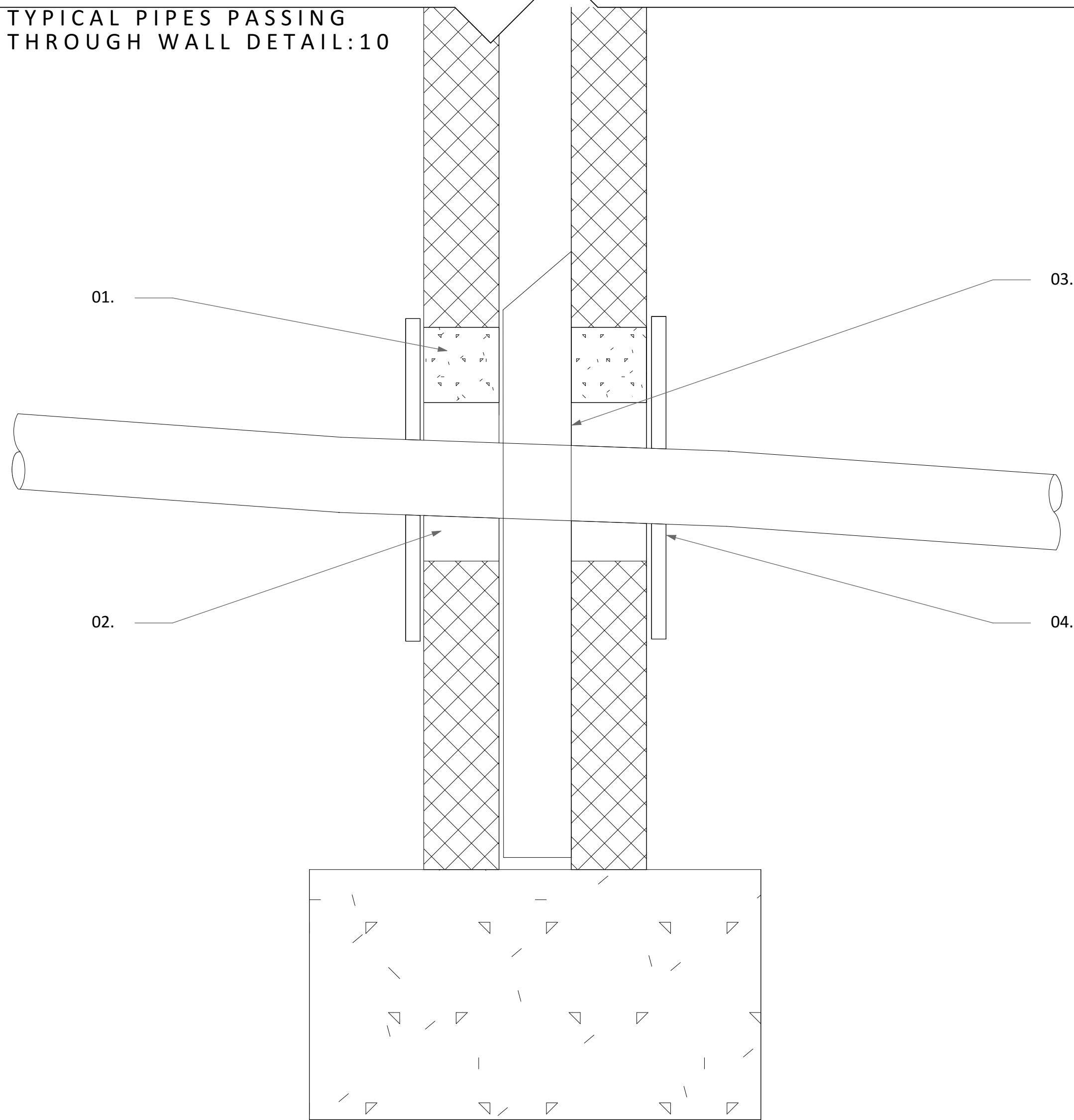

TYPICAL PIPES PASSING
THROUGH WALL DETAIL:10

GENERAL NOTES :

These drawings are for the purposes of a Building Regulations Application and are to be read in conjunction with all other drawings and specifications relating to this project from contributing consultants.

- Considerations
- The construction works are to conform and comply with all current and relevant sections of the Approved Documents and supporting documents of the Building Act 1984 and the Building Regulations 2010 and all subsequent amendments together with British Standards and Codes of Practice.
 - All work is to be to the completed to the satisfaction of the Approved Building Control Officer.
 - The Contractor should be familiar with the relevant Codes of Practice and Building Regulations, ensure that the Building Control Officer is contacted at the relevant work stages, checking all dimensions and conditions prior to commencement of works on site. Any discrepancies that may arise must be reported to the Architect.
 - All elements of structure to have a minimum 30-minute fire resistance.
 - Prior to the inauguration of any demolition works, a pre-commencement Demolition Survey will be commissioned and subsequently adhered to and ensure Asbestos, Deleterious and other harmful materials are identified and safely removed from site. Prior to any demolition works commencing, all structure to be adequately pinned and propped.
 - All new structural timbers are to be FSC approved, stress graded, tanalised treated and kiln stamped in line with the Structural Engineers Specification, ensure that all cut ends and notches brush treated with Protim or similar.
 - The manufacturers recommendations are to be followed in respect of the installation and fixing of all products and any discrepancies between those recommendations and any other requirement of the specification or drawings should be reported back to MVL Architects & Surveyors. Deviation from this drawing will be not permitted without prior written consent.

GAS
All Gas installations & Gas heating works are to be carried out by a Gas Safe registered contractor who will provide certificates on completion of the works to satisfy Building Control. All operation manuals, certificates of installation, warranties to form part of the Operation and Maintenance manual.

Electrical
All electrical work required to meet the requirements of Part P (Electrical safety) must be designed, installed, inspected, and tested by a person competent to do so.
Prior to completion Building Control must be satisfied that either:
A. An electrical installation certificate issued under the Competent Person Scheme has been issued; or
B. Appropriate certificates and form defined in BS 7671 have been submitted that confirm that the work has been inspected and tested by a competent person. A competent person will have sound knowledge and experience relevant to the nature of the work undertaken and to the technical standards set down in BS 7671, be fully versed in the inspection and testing procedures contained in the regulations and employ adequate testing equipment.

Construction (Design and Managment) Regulations 2015 CDM
These proposals fall within the requirements of the Construction (Design and Management) Regulations 2015. The Client is responsible for the appointment of the CDM designer and Principal Contractor. The Principal Contractor will be required to perform the construction tasks in accordance with the Health and Safety plan and to adopt them during the course of the construction process and to implement the requirements given to them by the CDM Designer during site visits.

Party Wall
Party Wall Act: The owner has a duty to serve a party structure notice to any adjoining owner if works are to be carried out to a party wall, structure, or line of junction; or if works involve excavations lower than the foundations of a neighbouring building within 3m, or excavations cut through a 45° line from the foundations of a neighbouring building within 6m. A party wall agreement/award should be formalised before the commencement of the works.

TENDER ISSUE

- DETAIL 09 KEY:**
- Plasterboard with a minimum mass per unit area 15kg/m² with staggered joints.
 - Timber framing.
 - 25mm of unfaced mineral wool absorbent material minimum density 10kg/m³ wrapped around pipe.

- DETAIL 10 KEY:**
- Lintelled opening to give 50mm space around pipe.
 - Provide 50mm clearance around pipes or a sleeve with 50mm clearance. Ensure adequately sealed.
 - Void filled with compressible material to prevent entry of gas.
 - Opening masked both sides with ridgid sheet material.

Rev B 10/07/2025 MVL Amended drawings for tender issue.
Rev A 20/06/2025 MVL Amended drawings following meeting with Client 06/06/2025

REVISIONS	ID	DATE	BY	COMMENTS
DRAWING TITLE		Detail: External Wall		
JOB		Horley Town Council		
		Horley Town Council 92 Albert Road Horley Surrey RH6 7HZ		
CLIENT		Mr Sam Adeniji		
INSTIGATION DATE		SCALE	DRAWN BY:	CHECKED BY:
		1:5 @ A1		CVL
DRAWING No.		REVISION:		
L-1886-4-400				B

M V L ARCHITECTS & SURVEYORS
MALCOLM V. LELLIOTT
19 CHURCH ST. GODALMING, SURREY, GU7 1EL
45 KINGS ROAD, ALTON, HAMPSHIRE, GU34 1PX
THE COACH HOUSE, DOCK STREET, PENARTH, CF64 2LA
E-MAIL: ADMIN@MVL-ARCHITECTS.CO.UK TEL. 01483 416 411
E-MAIL: ADMIN@MVL-ARCHITECTS.CO.UK TEL. 01420 375 083
E-MAIL: ADMIN@MVL-ARCHITECTS.CO.UK TEL. 02920 090 130