

Do not scale from drawings all working dimensions are to be taken on site

NOTES

ALL THE LIGHTING SMALL POWER HEATING
AND VENTILATION - POSITION SIZING AND
AND QUANTITY OF COMPONENTS IS
INDICATIVE ONLY A FULL WORKING DESIGN
IS TO BE DESIGNED/SUPPLIED AND
INSTALLED AS PART OF YOUR
CONTRACTORS DESIGN PORTION (CDP)
OBLIGATIONS AND AGREED WITH THE
CA/CLIENT PRIOR TO THE EXECUTION
PHASE:

Provide full design details as required for:

1. All lighting layouts and associated fittings
2. All small power requirements
3. All space heating requirements
4. All ventilation requirements
5. All cold water supply mains and tank fed
6. All hot/blended water requirements
7. RWH equipment upgrading
8. All above and below drainage requirements

ALL DESIGN TO MEET THE LATEST
STANDARDS OF THE DAY & BUILDING
REGUALIONS - REFER TO M&E
PERFORMANCE BRIEF REQUIREMENTS
PROVIDED FOR FURTHER DETAILS

DRAINAGE ABOVE AND BELOW GROUND

THE LAYOUT OF THE ABOVE AND BELOW
GROUND DRAINAGE IS INDICATIVE ONLY -
YOU ARE TO DESIGN AND CARRYOUT ALL
WORK TO COMPLETE THE DRAINAGE
REQUIREMENTS AS REQUIRED TO SERVE
THE EXISTING AND NEW PAVILION
ARRANGEMENTS AS REQUIRED BY YOUR
CONTRACTORS DESIGN PORTION
OBLIGATIONS - ALLOW TO EXECUTE ALL
WORK REQUIRED TO MODIFY THE ABOVE
AND BELOW GROUND DRAINAGE RUNS BOTH
UNDER INTERIOR AND EXTERIOR MAKE GOOD
ALL EXTERNAL AND INTERNAL SURFACES
AS REQUIRED TO COMPLETION OF THE
WORKS - ALL DRAINAGE WORKS TO
COMPLY WITH PART H OF THE BUILDING
REGULATIONS AND THE LBGO

[illegible]

PROJECT NAME

ALTERATIONS & REFURBISHMENTS
SILEBY MEMORIAL PARK SPORT PAVILION
SEAGRAVE ROAD
SILEBY, LEICESTERSHIRE
FOR SILEBY PARISH COUNCIL

SCALE NTS A1	DWG NO. SSP/2025 002C_P1	REV
DATE JULY 2025	DRAWN DRI/NR	CHKD SPC

AMLI Design
Architectural Consultancy

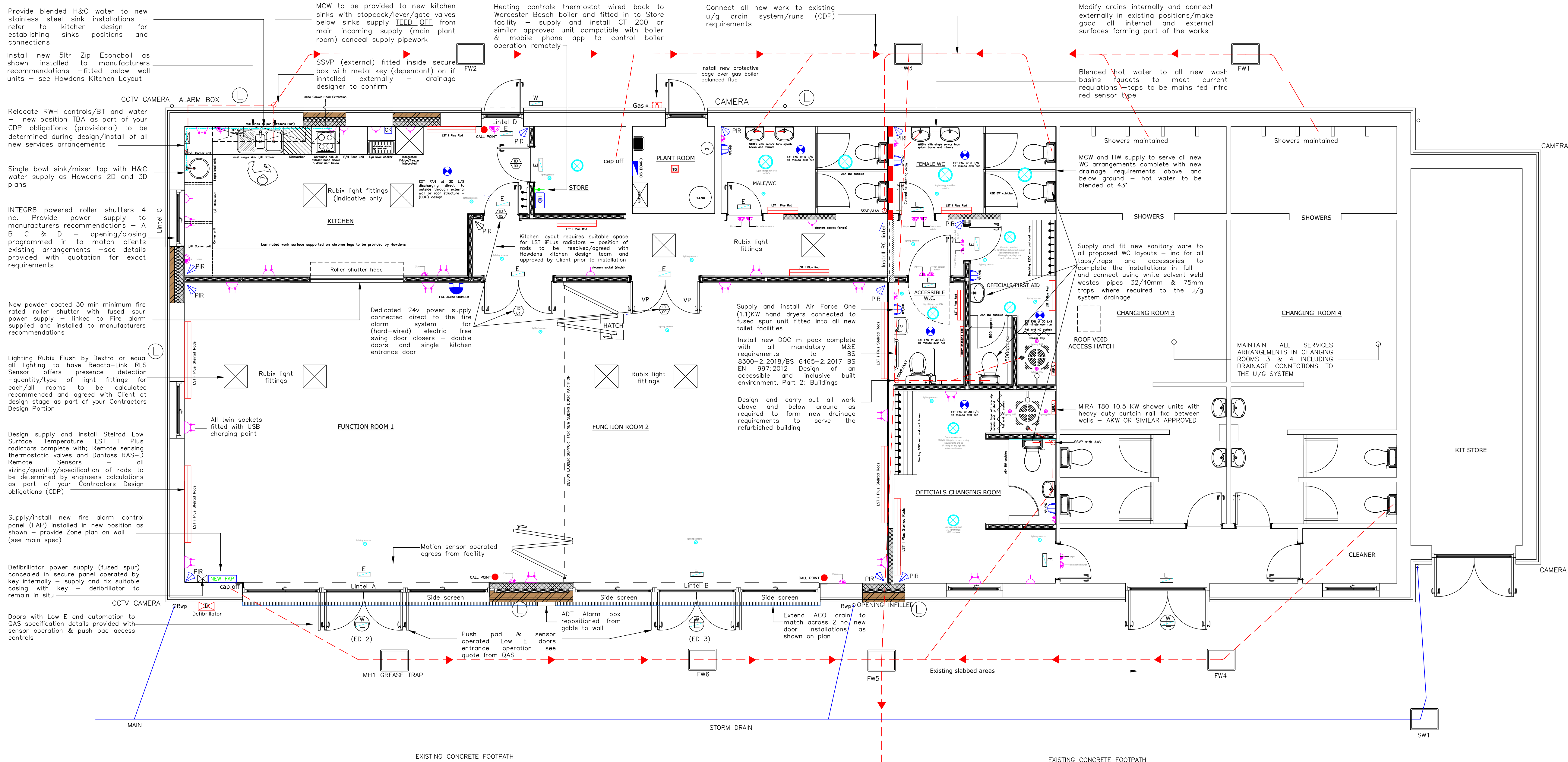

MECHANICAL/ELECTRICAL/DRAINAGE LAYOUT INDICATIVE (FOR INFORMATION ONLY)

KEY:

- | | | | |
|---|--------------------------------------|---|--|
|  | IN-LINE EXTRACTOR HOOD |  | BREAK GLASS CALL POINT |
|  | COOKER POINT |  | EMERGENCY LIGHT WITH FIRE EXIT SIGN |
|  | EXTRACT FAN/THROUGH ROOF OR WALLS |  | EMERGENCY LIGHT (WATERPROOF) |
|  | FIRE ALARM PANEL |  | EXTERNAL LIGHT |
|  | FIRE ALARM SOUNDER PANEL |  | LST + PLUS RADIATORS |
|  | SINGLE SOCKETS (CLEANERS) |  | WALL THERMOSTAT |
|  | DOUBLE SOCKETS WITH USB PORT |  | HAND DRYER (AIR FORCE ONE) |
|  | FUSED SPUR |  | BOSCH CT 200 OR SIMILAR EXTERNAL CONTROL UNIT FOR USE WITH MGB APP |
|  | EXTRA RUBIX LIGHT FITTINGS |  | DEFIBRILLATOR |
|  | PRESENCE DETECTION SENSORS |  | PIR |
|  | LIGHT FITTINGS (CORROSION RESISTANT) |  | MIRA SPORT 10.5 KW SHOWER UNIT |
|  | SPOT LIGHTING IN SHOWERS IP65 |  | BELOW GROUND FOUL DRAINAGE |
|  | DIS BOARD |  | BELOW GROUND STORM DRAINAGE |

GENERAL ARRANGEMENT DRAWINGS - TENDER ISSUE